

# Frame Round / Wall Frame Round Maxi



220-240V, 50/60Hz

<p>Frame Round/Wall</p> <p>Frame Round Maxi</p>	
<p>ca. 10° (max. 20°) Max. 16A</p> <p>0,5 - 1,0 mm<sup>2</sup> 8 mm</p> <p>1,5 - 2,5 mm<sup>2</sup> 12 mm</p>	<p>Frame Sensor</p>
	<p><b>NO:</b> Skru av strømmen før montering.  <b>DK:</b> Sluk for strømmen inden montering.  <b>SE:</b> Stäng av strømmen innan montering.  <b>EN:</b> Turn off power before installing.  <b>FR:</b> Couper le courant avant l'installation.  <b>NL:</b> Stroom uitschakelen voor u het toestel installeert.  <b>DE:</b> Vor Installationsarbeiten den Strom abschalten.  <b>FI:</b> Sammuta virta ennen kytkemistä</p> <p><b>NO:</b> Kan kun installeres og vedlikeholdes av en registrert installasjonsvirksomhet.  <b>DK:</b> Må kun installeres og vedligeholdes af uddannet elektriker.  <b>SE:</b> Skall installeras och underhållas av behörig elektriker.  <b>EN:</b> Only to be installed and maintained by an authorized electrician.  <b>FR:</b> Doit être installé et maintenu par un électricien qualifié.  <b>NL:</b> Mag alleen geïnstalleerd en onderhouden worden door een bevoegde electricien.  <b>DE:</b> Dieses Produkt darf nur durch autorisiertes Personal (z.B. Elektro-Installateur) angeschlossen, in Betrieb genommen und gewartet werden.  <b>FI:</b> Asentaa ja huolttaa saa vain valtuutettu sähköasentaja</p>

**NORWAY**  
SG Armaturen AS

Skytterheia 25  
N-4790 Lillesand

Tel: +47 37 50 03 00  
firmapost@sg-as.no  
www.sg-as.no

**SWEDEN**

SG Armaturen AB  
Tel: +46 31 81 71 10  
info@sg-ab.se  
www.sg-ab.se

**FINLAND**

SG Armaturen Oy  
Tel: +358 02 07 30 39 60  
info@sg-oy.fi  
www.sg-oy.fi

**DENMARK**

SG Armaturen A/S  
Tel: +45 70 70 72 13  
info@sg-as.dk  
www.sg-as.dk

**UNITED KINGDOM**

SG Lighting LTD  
Tel: +47 37 50 03 00  
info@sglighting.co.uk  
www.sglighting.co.uk

**FRANCE**

SG Lighting SA/NV  
Tel: +33(0) 4 94 93 00 00  
info.france@sglighting.fr  
www.sglighting.net

**BENELUX**

SG Lighting SA/NV  
Tel: +32(0) 15 20 72 71  
info.benelux@sglighting.net  
www.sglighting.net

**GERMANY**

SG Leuchten GmbH  
Tel: +49 40 23 99 44 59  
info@sg-leuchten.de  
www.sg-leuchten.de

**INTERNATIONAL**

SG Lighting Co Ltd.  
Tel: +86 769 88 49 20 88  
cindy@sgdgc.com  
www.sg-as.com

# Dipswitch

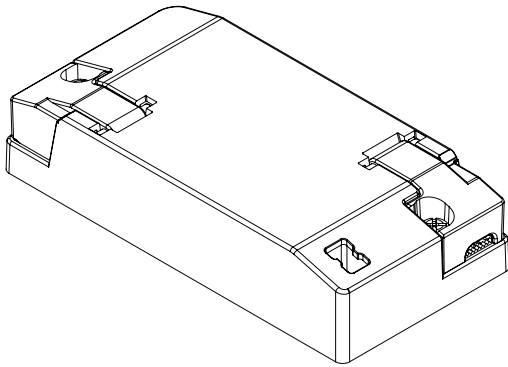

Standard

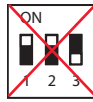
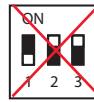
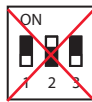

<b>mA</b>	<b>200</b>	250	300	350	400	450
<b>Im</b>	<b>100%</b>	125%	-	-	-	-

Frame Round/Wall

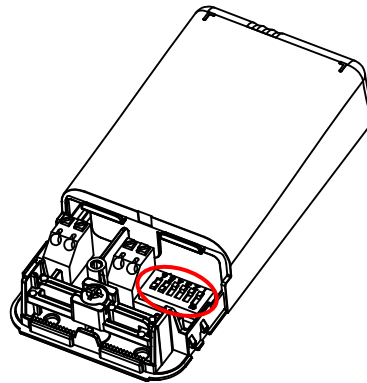
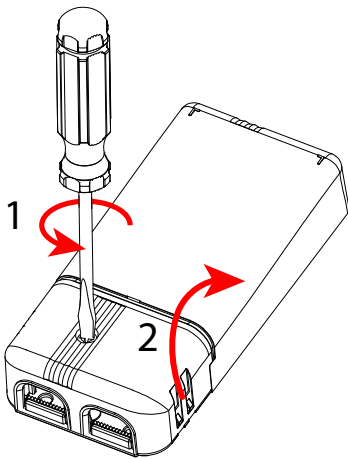

<b>mA</b>	250	300	350	400	450	500
<b>Im</b>	42%	50%	58%	67%	75%	83%

Frame Round Maxi

Standard



<b>mA</b>	550	<b>600</b>	650	<del>700</del>	<del>750-900</del>	<del>12/24/28V</del>
<b>Im</b>	92%	<b>100%</b>	108%	<del>-</del>	<del>-</del>	<del>-</del>

# Sensor Dim

## Motion and daylight

**No Com**

**With Com**

**No Push**

**Push**

		1	2
Hold time	10 minutes	1	1
	5 minutes	0	1
	1 minute	1	0
	5 seconds	0	0

		3	4
Motion sensitivity	High	1	1
	Medium	0	1
	Low	1	0
	Off	0	0

		5	6
Daylight sensitivity	Low	1	1
	Medium	0	1
	High	1	0
	Off	0	0

		7
Midnight cut	On	1
	Off	0

		8
Basic light	On	1
	Off	0

- |   |  |  |   |   |
|---|--|--|---|---|
| <p><b>NORWAY</b><br/>SG Armaturen AS<br/>Skytterheia 25<br/>N-4790 Lillesand<br/>Tel: +47 37 50 03 00<br/>firmapost@sg-as.no<br/>www.sg-as.no</p> | <p><b>SWEDEN</b><br/>SG Armaturen AB<br/>Tel: +46 31 81 71 10<br/>info@sg-ab.se<br/>www.sg-ab.se</p>                         | <p><b>DENMARK</b><br/>SG Armaturen A/S<br/>Tel: +45 70 70 72 13<br/>info@sg-as.dk<br/>www.sg-as.dk</p>                         | <p><b>FRANCE</b><br/>SG Lighting SA/NV<br/>Tel: +33(0) 4 94 93 00 00<br/>info.france@sglighting.fr<br/>www.sglighting.net</p> | <p><b>GERMANY</b><br/>SG Leuchten GmbH<br/>Tel: +49 40 23 99 44 59<br/>info@sg-leuchten.de<br/>www.sg-leuchten.de</p> |
| <p><b>FINLAND</b><br/>SG Armaturen Oy<br/>info@sg-oy.fi<br/>www.sg-oy.fi</p>  | <p><b>UNITED KINGDOM</b><br/>SG Lighting LTD<br/>Tel: +47 37 50 03 00<br/>info@sglighting.co.uk<br/>www.sglighting.co.uk</p> | <p><b>BENELUX</b><br/>SG Lighting SA/NV<br/>Tel: +32(0) 15 20 72 71<br/>info.benelux@sglighting.net<br/>www.sglighting.net</p> | <p><b>INTERNATIONAL</b><br/>SG Lighting Co Ltd.<br/>Tel: +86 769 88 49 20 88<br/>cindy@sgdgc.com<br/>www.sg-as.com</p>        |   |

### Hold time

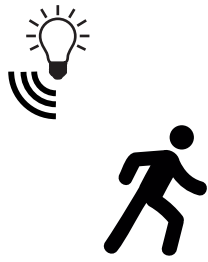
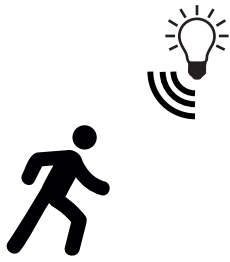

	1	2
10 min	1	1
5 min	0	1
1 min	1	0
5 sec	0	0



### Motion sensitivity

Sensitivity	3	4
High	1	1
Medium	0	1
Low	1	0
Off	0	0

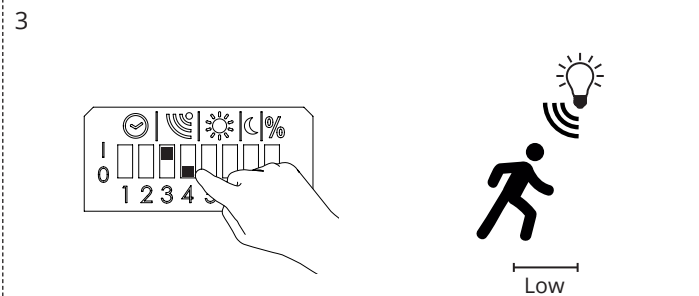
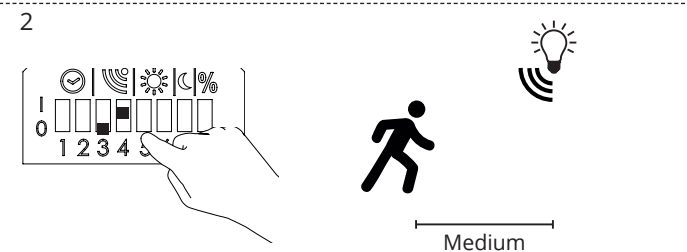
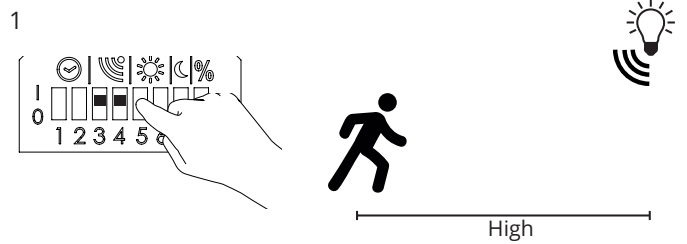
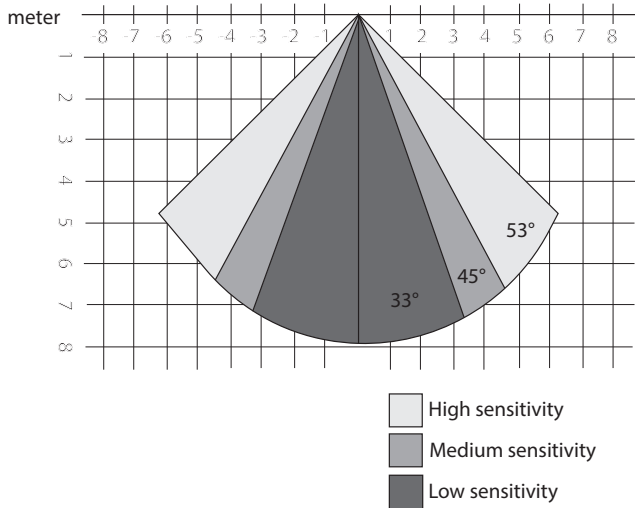

### Daylight sensitivity

Sensitivity	5	6
Low	1	1
Medium	0	1
High	1	0
Off	0	0

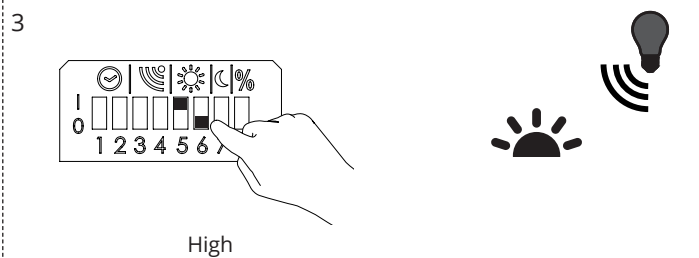
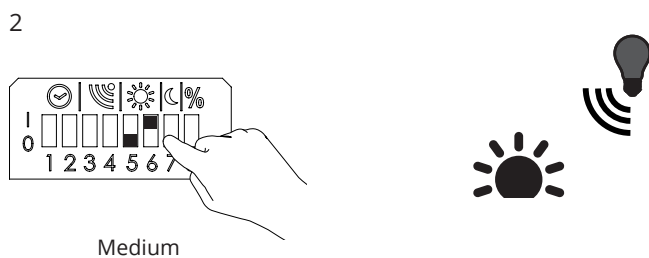
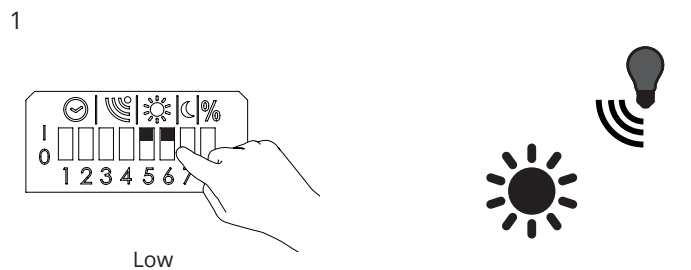

### Midnight cut

~00:00 - 05:00 AM

~00:00 - 05:00 AM

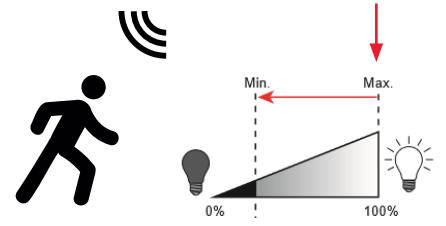
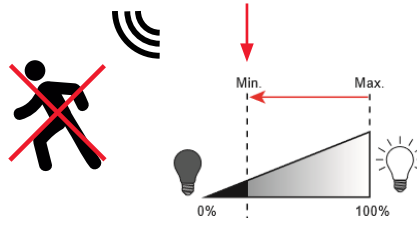
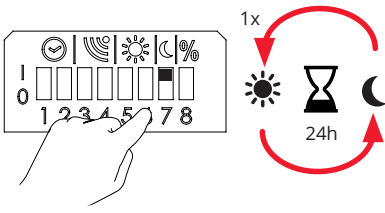

### Light levels - Basic light and max light

1

2

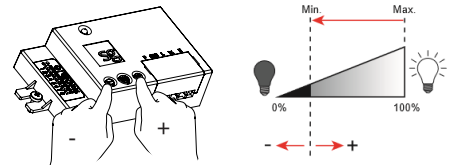
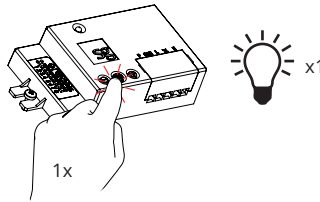
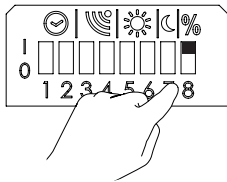

Basic light

3

4

5

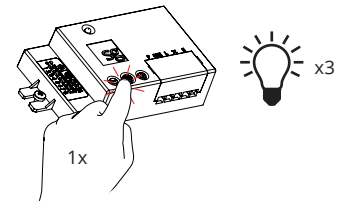
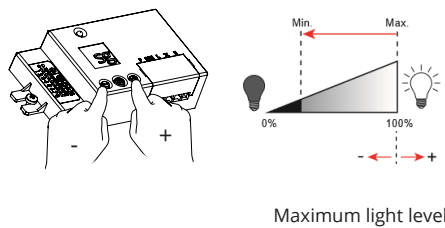
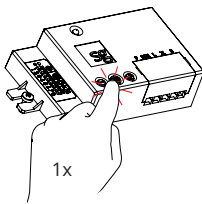

### Light levels - Midnight cut

1

2

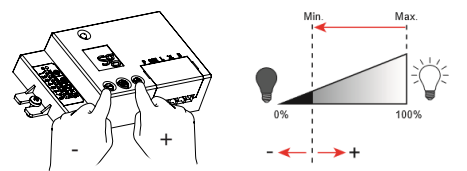
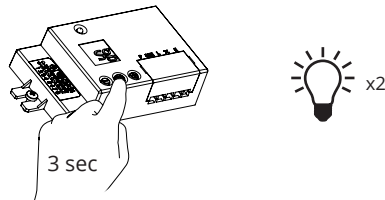
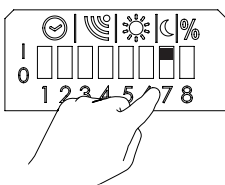

Minimum midnight cut

3

4

5

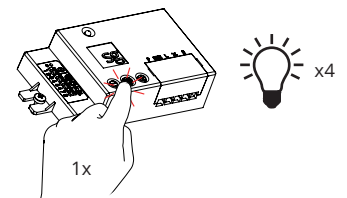
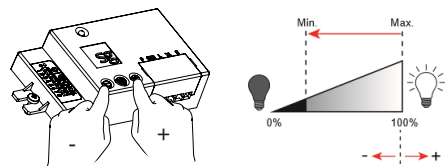
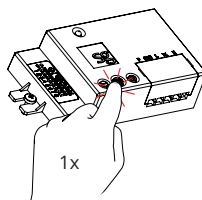

Maximum midnight cut